

PREPARED BY:  
 AERIAL SURVEY AND PHOTO, INC.  
 546 AIRPORT ROAD PO BOX 659  
 NORRIDGEWOCK, MAINE 04957  
 TEL: 207 634-2006 FAX 207 634-2008

NOTE  
 THIS MAP IS FOR ASSESSMENT PURPOSES ONLY  
 AND IS NOT INTENDED FOR PROPERTY CONVEYANCE  
 OR LEGAL DESCRIPTION.

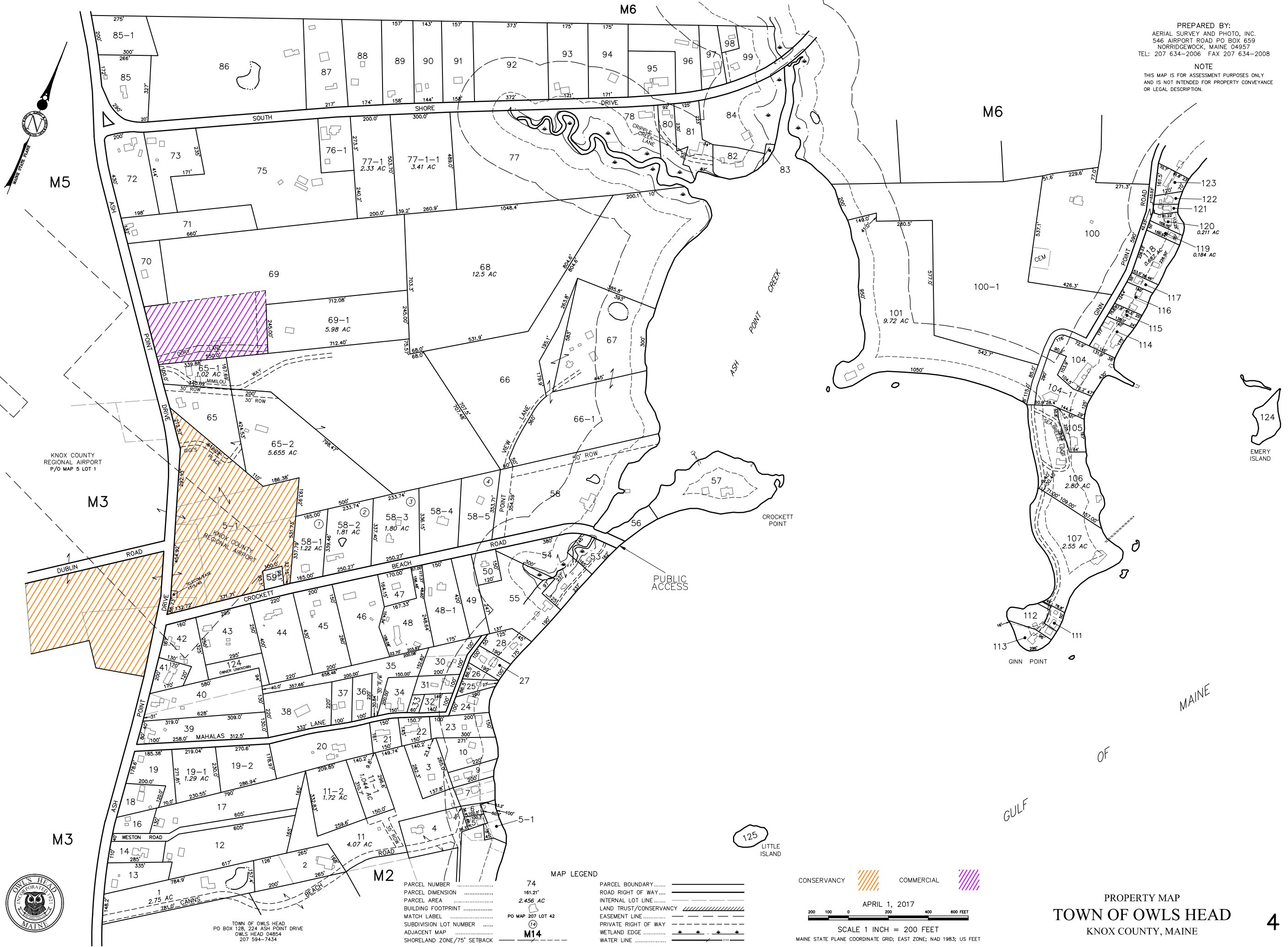

M5

M6

M6

M3

M3

M2



TOWN OF OWLS HEAD  
 PO BOX 128, 224 ASH POINT DRIVE  
 OWLS HEAD 04854  
 207 594-7434

PARCEL NUMBER	74
PARCEL DIMENSION	161.21'
PARCEL AREA	2.456 AC
BUILDING FOOTPRINT	
MATCH LABEL	
SUBDIVISION LOT NUMBER	
ADJACENT MAP	PO MAP 207 LOT 42
SHORELAND ZONE/75' SETBACK	M14

MAP LEGEND	
PARCEL BOUNDARY	.....
ROAD RIGHT OF WAY	=====
INTERNAL LOT LINE	-----
LAND TRUST/CONSERVANCY	
EASEMENT LINE	-----
PRIVATE RIGHT OF WAY	-----
WETLAND EDGE	~~~~~
WATER LINE	~~~~~

CONSERVANCY COMMERCIAL

APRIL 1, 2017

SCALE 1 INCH = 200 FEET

MAINE STATE PLANE COORDINATE GRID; EAST ZONE; NAD 1983; US FEET

PROPERTY MAP  
 TOWN OF OWLS HEAD  
 KNOX COUNTY, MAINE